

On-Grid PV Inverter

Installation and Operation Manual

www.aforeenergy.com



Version: S06018-02



Afore New Energy Technology (Shanghai) Co., Ltd.

T 86-21-54326236 F +86-21-54326136 E info@aforeenergy.com

Ad Building 7, No.333 Wanfang Rd, Minhang District, Shanghai, China. 201112



Afore New Energy Technology (Shanghai) Co., Ltd.

Contents

1.About This Manual	1
1.1 Scope of Validity	1
1.2 Target Group	1
1.3 System Diagram	1
2.Safety & Symbols	2
2.1 Safety Precautions	2
2.2 Explanations of Symbols	3
3.Installation	4
3.1 Package	4
3.2 Product Overview	5
3.3 Mounting Location	6
3.4 Installation On-grid PV Inverter	7
3.5 Electrical Connection	8
3.5.1 PV Connection	8
3.5.2 Grid Connection	10
3.5.3 Communication Connection (WIFI / Ethernet / GPRS / RS485)	12
4.Operation	14
4.1 Control Panel	14
4.2 Menu Structure	15
4.3 Setting	16
4.3.1 Startup Setting.	16
5.Commissioning	17
6.Shut Down & Restart the Inverter	18
6.1 Shut Down Procedures	18
6.2 Restart the inverter	18
7.Maintenance&Trouble Shooting	18
7.1 Maintenance	18
7.2 Fault Code and Trouble Shooting	18
8.Specifications	20

1.About This Manual

1.1 Scope of Validity

This manual describes the installation, commissioning, operation and maintenance of the following on-grid PV inverters produced by Afore New Energy:

Single-Phase(Two MPPT Trackers)

HNS3000TL HNS3600TL HNS4000TL HNS5000TL
HNS6000TL

Single-Phase(One MPPT Tracker)

HNS3600TL-1

Please keep this manual all the time available in case of emergency.

1.2 Target Group

This manual is for qualified personnel. The tasks described in this manual must only be performed by qualified personnel.

1.3 System Diagram

The typical connection diagram for the entire PV system is on-grid.

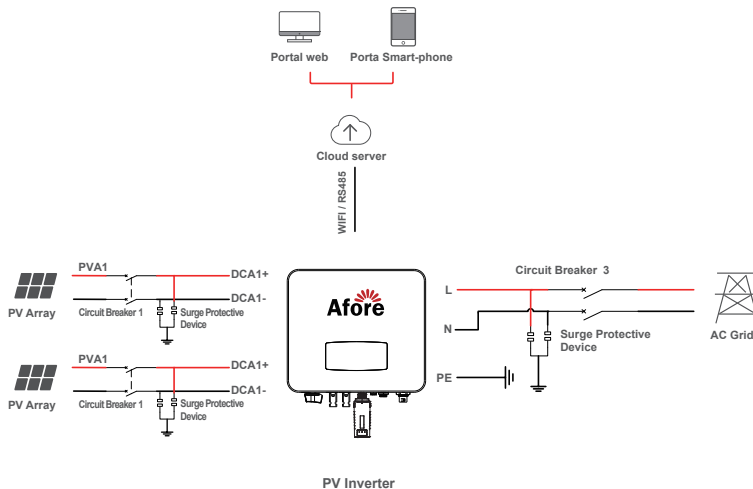

Circuit Breaker and Surge Protector Recommendation:

Type	Max AC Current [A]	Rated current of AC breaker[A]
Single-Phase(Two MPPT Trackers)		
HNS3000TL	15	25
HNS3600TL	18	25
HNS4000TL	20	32
HNS5000TL	23	32
HNS6000TL	28	40
Single-Phase(One MPPT Tracker)		
HNS3600TL-1	18	25

- SPD: Lightning protection system, refer to the following options:
- AC side, nominal discharge current 20KA, second grade lightning protection, protection voltage 2.5KV
- DC side, nominal discharge current 20KA, second grade lightning protection, protection voltage 3.2KV
- The wiring distance between the inverter and the distribution box should be at least 5 meters.



Note:

The Inverter can be only connected to low-voltage grid.
(220/230Vac, 50/60Hz).

2.Safety & Symbols

2.1 Safety Precautions

1. All work on the inverter must be carried out by qualified electricians.
2. The device may only be operated with PV panels.
3. The PV panels and inverter must be connected to the ground.
4. Do not touch the inverter cover until 5 minutes after disconnecting both DC and AC power supply.

5. Do not touch the inverter enclosure when operating, keep away from materials that may be affected by high temperatures.
6. Please ensure that the used device and any relevant accessories are disposed of in accordance with applicable regulations.
7. Afore inverter should be placed upwards and handled with care in delivery. Pay attention to waterproof. Do not expose the inverter to water, rain, snow or spray.
8. Alternative uses, modifications to the inverter not recommended. The warranty can become void if the inverter was tampered with or if the installation is not in accordance with the relevant installation instructions.

2.2 Explanations of Symbols

Afore inverter strictly comply with relevant safety standards. Please read and follow all the instructions and cautions during installation, operation and maintenance.



Danger of Electric Shock.

The inverter contains fatal DC and AC power. All work on the inverter must be carried out by qualified personnel only.



Beware of hot surface

The inverter's housing may reach uncomfortably hot 60C (140F) under high power operation. Do not touch the inverter enclosure when operation.



Residual Power Discharge

Do not open the inverter cover until 5 minutes after disconnection both DC and AC power supply



Important Notes

Read all instructions carefully. Failure to follow these instructions, warnings and precautions may lead to device malfunction or damage.



Do not dispose of this device with the normal domestic waste.



Without Transformer.

This inverter does not use transformer for the isolation function.



CE mark.

The inverter complies with the requirements of the applicable CE guidelines.



Refer to manual before service.

3.Installation

3.1 Package

Unpacking

On receiving the inverter, please check to make sure the packing and all components are not missing or damaged. Please contact your dealer directly for supports if there is any damage or missing components.

Package List

Open the package, please check the packing list shown as below.

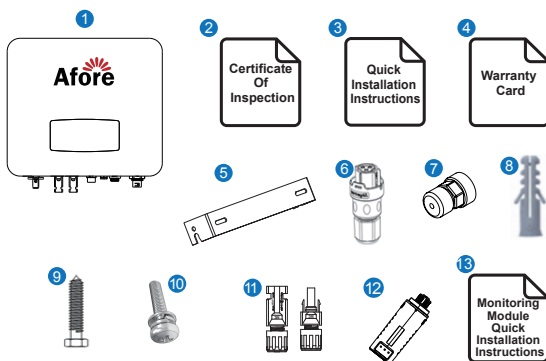

No.	Qty	Items	No.	Qty	Items
1	1	Solar inverter	8	2	Plastic Expansion Tube
2	1	Certificate Of Inspection	9	2	Tapping Screw
3	1	Quick Installation Instructions	10	1	Security Screw
4	1	Warranty Card	11	1/2	DC Connector sets
5	1	Wall Mounting Bracket	12	1	Monitor Module
6	1	AC Connector	13	1	Monitoring Module Quick Installation Instructions
7	1	Zero-Injection Connector(Optional)			



Note: The HNS3600TL-1 is 1 pair of DC plug connector, the HNS3000-6000TL is 2 pairs.

3.2 Product Overview

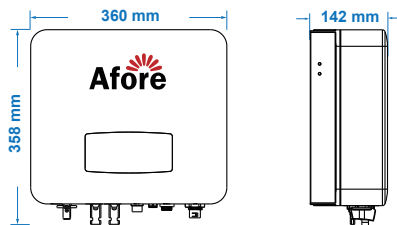

Overview of the Connection Area

The following picture shows the assignment of the individual connection areas on the bottom of the inverter.

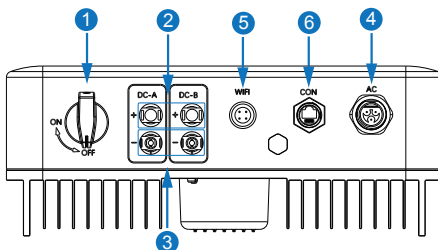

No.	Items
1	DC Switch
2	DC Connectors (+) For PV Strings
3	DC Connectors (-) For PV Strings
4	AC Connector
5	Monitor Module Port
6	Zero-Injection Port (Optional)

3.3 Mounting Location

The inverters are designed for indoor and outdoor installation (IP65), to increase the safety, performance and lifespan of the inverter, please select the mounting location carefully based on the following rules:

- The inverter should be installed on a solid surface, far from flammable or corrosion materials, where is suitable for inverter's weight and dimensions.
- The ambient temperature should be within $-25^{\circ}\text{C} \sim 60^{\circ}\text{C}$ (between -13°F and 140°F).
- The installation of inverter should be protected under shelter. Do not expose the inverter to direct sunlight, water, rain, snow, spray lightning, etc.

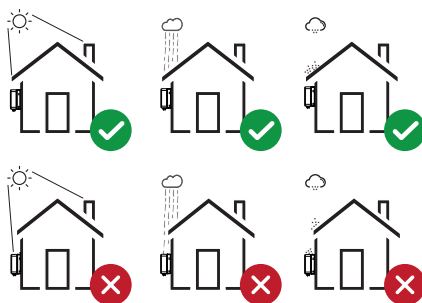

- The inverter should be installed vertically on the wall, or lean back on plane with a limited tilted angle. Please refer to below picture.

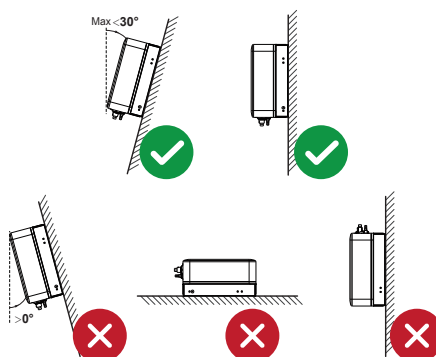

- Leave the enough space around inverter, easy for accessing to the inverter, connection points and maintenance.

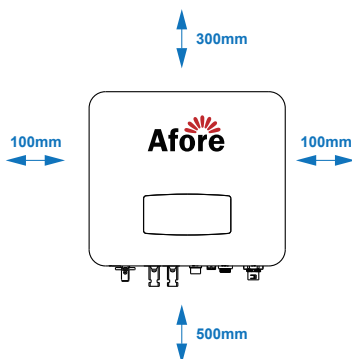

3.4 Installation On-grid PV Inverter

Step 1

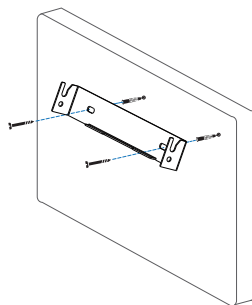
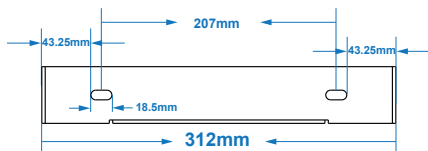

Step 2

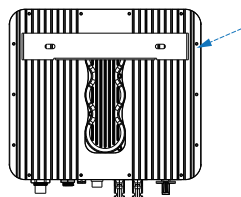
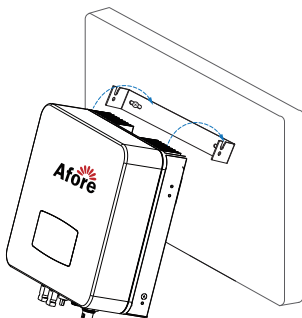

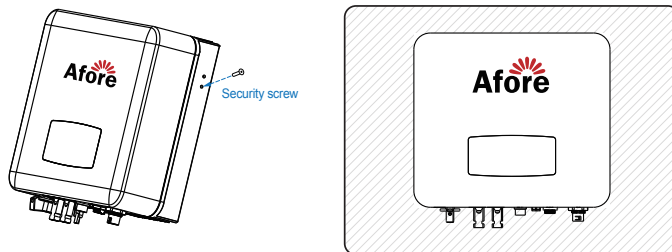
Step 3

3.5 Electrical Connection

3.5.1 PV Connection

The inverter is equipped with 2 MPPT channels, each of which contains a PV string input. For best results, please ensure that each MPPT channel is connected to a PV string separately. Otherwise, the inverter will activate voltage or automatic current protection.

- The open-circuit voltage and short-circuit current of PV string must not exceed inverter's range
- The isolation resistance between PV string and ground must exceed 10 kΩ
- The polarity from PV strings are correct
- Use the DC plugs in the accessory
- The lightning protector should be equipped between PV strings and inverter
- Disconnect all of the PV (DC) switch during wiring

Warning:

The fatal high voltage may on the DC side, please comply with electric safety when connecting.

Please make sure the cable connected in correct polarity with inverter, otherwise inverter could be damaged.

Step 1

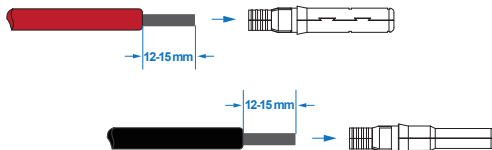

Note:
PV cable suggestion
Cross-section
4 mm²

Step 2

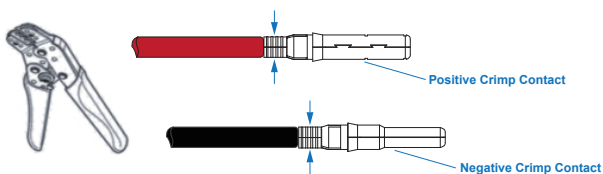

Note:
Please use PV connector crimper

Step 3

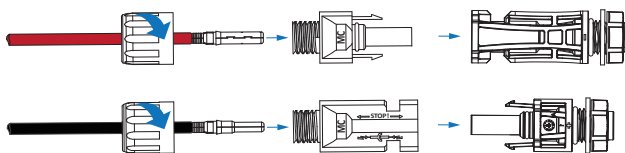

Note:
You'll hear click sound when
the connector assembly is correct

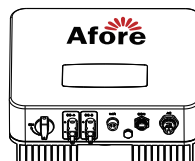

Note:

It is strongly recommended to connect by two strings of panels for models of two MPPT channels, e.g. HNS3000-6000TL. 210 solar panels should connect from PV side A and B as the Y-shaped, setting PV model parallel and PV side voltage not exceed 500V one MPPT; other solar panels we recommend you though dual MPPT input the cables, also no exceed 450V

3.5.2 Grid Connection

The on-grid PV inverters work with grid (220/230/240 Vac, 50/60 Hz).

The external AC switch should be installed between inverter and grid to isolate from grid. Please make sure below requirements are followed before connecting AC cable to the inverter.

- The AC (grid) voltage must not exceed inverter's range
- The phase-line from AC distribution box are correctly connected
- Use the AC plugs in the accessory
- The surge protector should be equipped between grid and inverter
- Disconnect the AC (grid) switch during wiring



Warning:

The fatal high voltage may on the AC side, please comply with electric safety when connecting.
Please make sure the right line of AC grid connected with inverter, otherwise inverter could be damaged.

Step 1

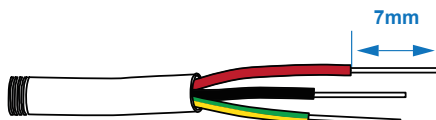

Note:
AC cable suggestion
Cross-section
4 mm²

Step 2

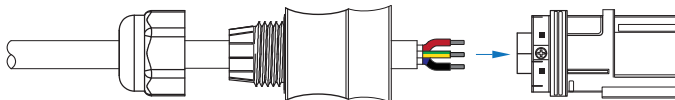

AC line goes through AC terminal waterproof head and cap

Step 3

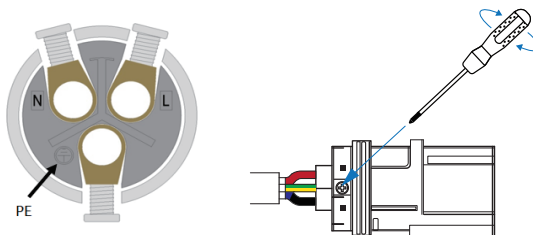

Connect AC line, Live line (L), Neutral line (N) and Ground Wire (PE) according to polarity.

Step 4

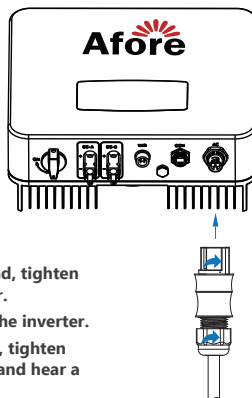

1. Connect AC terminals and waterproof head, tighten the cap, make sure they clip closely together.
2. Connect AC connector to AC terminal of the inverter.
3. After making sure that it is firmly inserted, tighten the sleeve on the AC connector to the right and hear a click.

3.5.3 Communication Connection

The monitoring module could transmit the data to the cloud server, and display the data on the PC, tablet and smart-phone.

Install the WIFI / Ethernet / GPRS / RS485 Communication

WIFI / Ethernet / GPRS / RS485 communication is applicable to the inverter. Please refer to "Communication Configuration Instruction" for detailed instruction.

Step 1

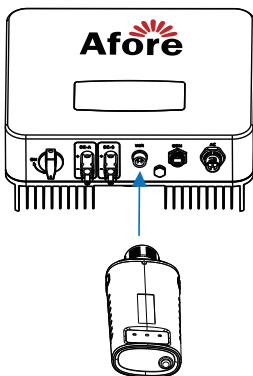

Step 2

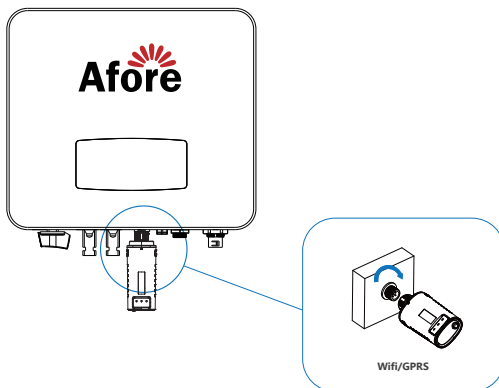

4.5 Zero-injection Smart Meter (Optional)

Smart meter is an intelligent control equipment which is used for on-grid inverters. Its main function is to measure the forward and reverse power on the grid-connected side, and transmit data to the inverter through RS485 communication to ensure that the power of the inverter is less than or equal to the user's home load, and no current flows into the grid.

Step 1

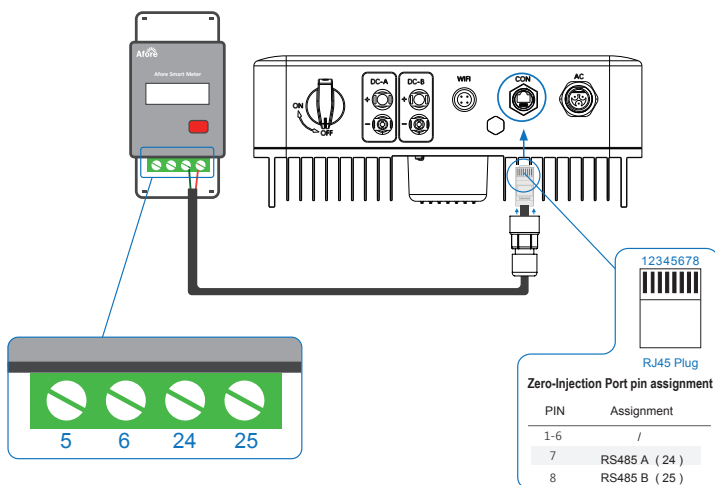

Note:

For single-phase inverter, please follow below pin order
 RS485A(Pin 7) to single-phase meter (Pin 24)
 RS485B(Pin 8) to single-phase meter (Pin 25)

Step 2

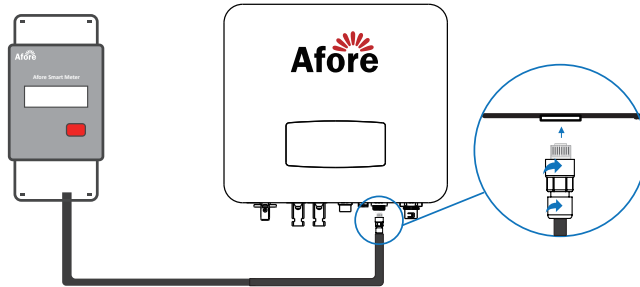

Note:

Please refer to "Zero Injection Smart Meter Installation and Operation Manual" for detailed instruction.

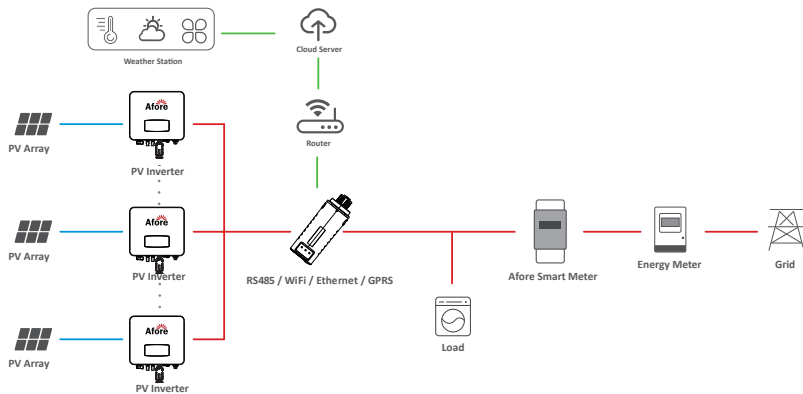

Note:

The Inverter could be connected in parallel with Smart Meter, make sure the total load power not exceed Smart Meter's limitation.

5.2 Menu Structure

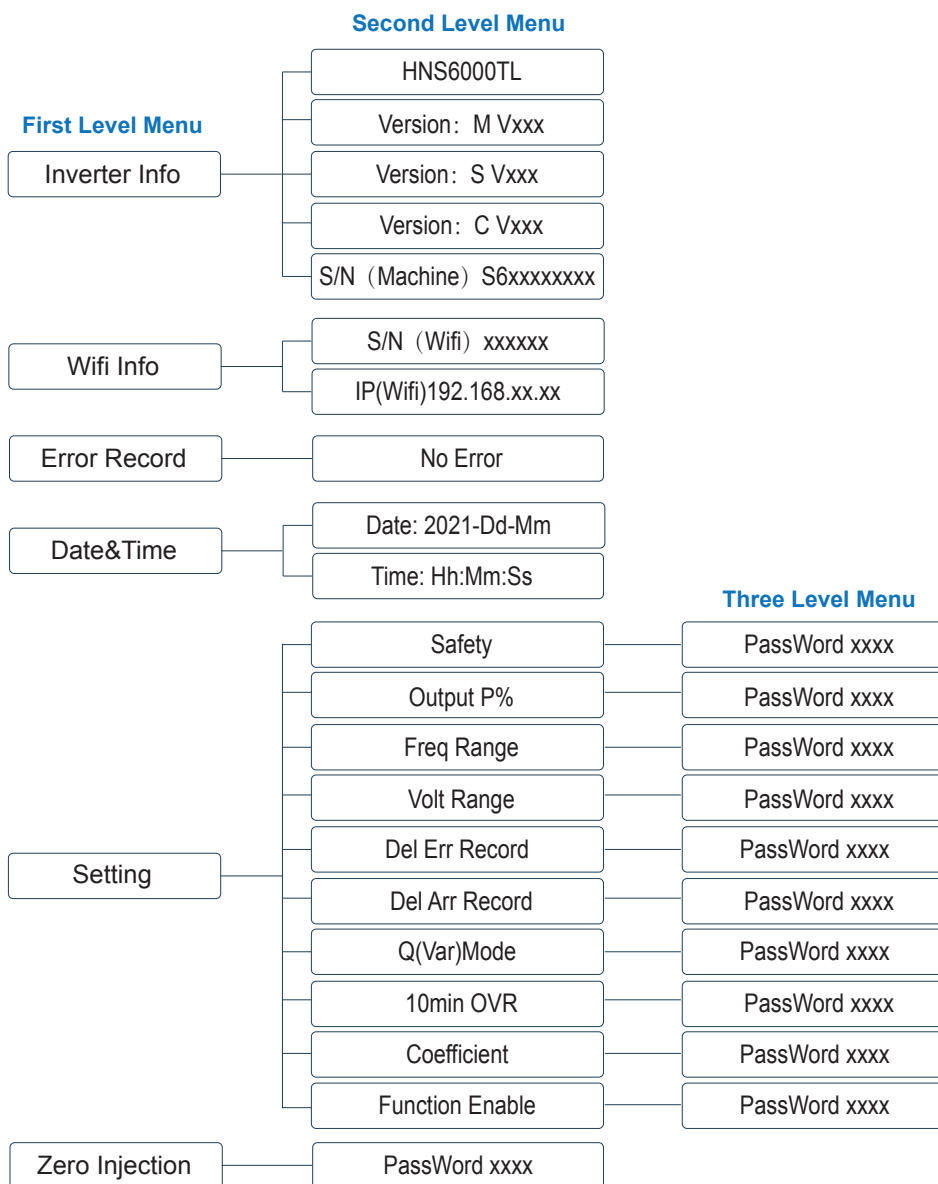

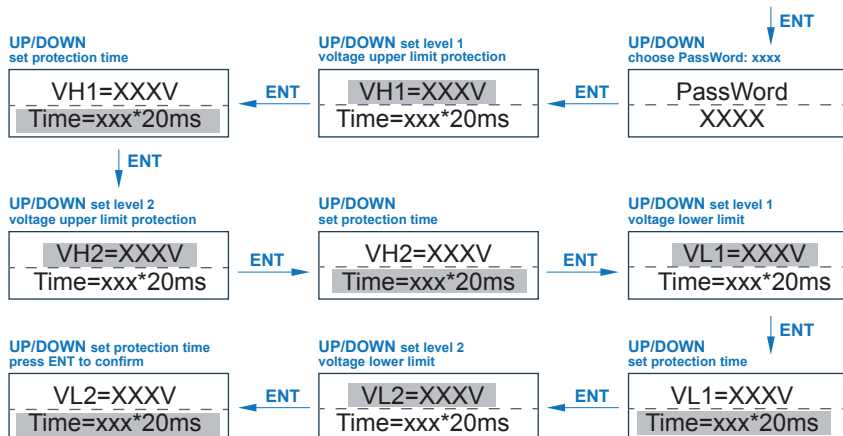

5.3.3 Frequency Range

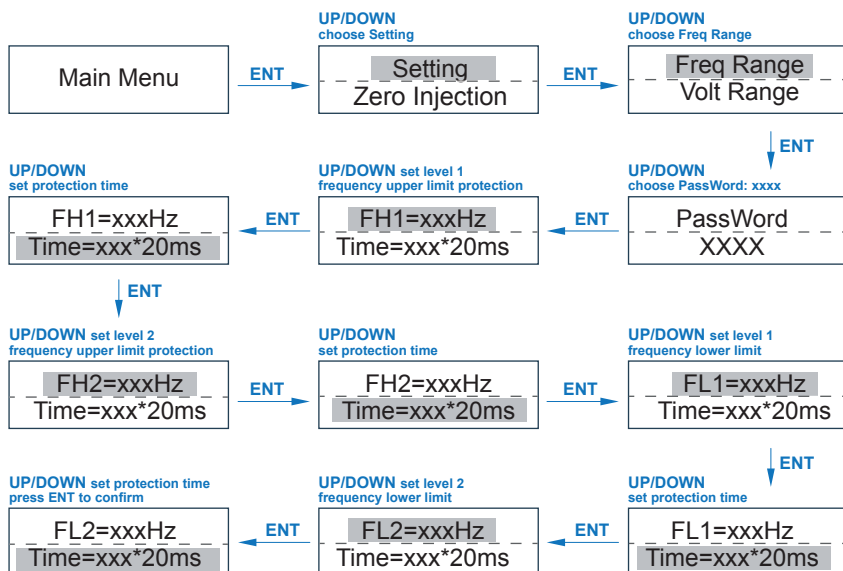

Note:

The parameters setting only works after the inverter is restarted.

Trouble-Shooting List

Type of Fault	Name	Description	Recommend Solution
PV Fault	Isolation Fault	The impedance between ground and PV (+) & PV (-) is too low, beyond the reasonable range.	<ul style="list-style-type: none"> • Check whether the battery and wiring are immersed in water and whether the insulation layer is damaged, and then make corrections. • If the fault occurs continuously and frequently, please ask help for local distributors.
	PV Volt Low	The DC input voltage from PV strings is below the minimum reasonable value.	<ul style="list-style-type: none"> • Reconfigure the PV strings by increasing the number of PV strings to increase DC input voltage. • Contact local distributors for suggestions and solutions.
	PV Volt High	The DC input voltage from PV strings is exceeding the maximum reasonable value.	<ul style="list-style-type: none"> • Reconfigure the PV strings by reducing the number of PV strings to decrease DC input voltage. • Contact local distributors for suggestions and solutions.
	PV1 Over Current	PV1 current is too high, protection is triggered.	<ul style="list-style-type: none"> • Power off, then restart (Ref. Chapter6) • If fault still occurs continuously and frequently, please ask help for local distributors.
	PV2 Over Current	PV2 current is too high, protection is triggered.	
Grid Fault	Island Fault	The public grid is outage or the grid is disconnected to the inverter.	<ul style="list-style-type: none"> • The fault will disappear automatically when the public grid go back to normal. • Contact the local distributor or grid company to adjust the voltage protection parameters.
	10min Over Volt	The 10-minute average value of the grid voltage is abnormal and beyond the protection range.	<ul style="list-style-type: none"> • Power off, then restart (Ref. Chapter6) • If fault still occurs continuously and frequently, please ask help for local distributors.
	Grid Volt Fault	Grid voltage is abnormal, beyond the protection range.	<ul style="list-style-type: none"> • The fault will disappear automatically when the grid voltage is back to normal. • If fault still occurs continuously and frequently, please ask help for local distributors.
	Grid Freq Fault	Grid frequency is abnormal, beyond the protection range.	<ul style="list-style-type: none"> • The fault will disappear automatically when the grid frequency is back to normal. • If fault still occurs continuously and frequently, please ask help for local distributors.

Explanation of LCD Display Content

Nouns	Explanation
Inverter Info	Display the serial number and firmware version of inverter
Error Record	Check the error list of inverter including date and time
Wifi Info	Display the WIFI serial number and assigned IP address
Date & Time	Set date and time of the inverter
Setting	Set the protection parameters of inverter
Function Enable	Countercurrent power switch
Zero Injection	Meter switch

5.3 Setting

5.3.1 Startup

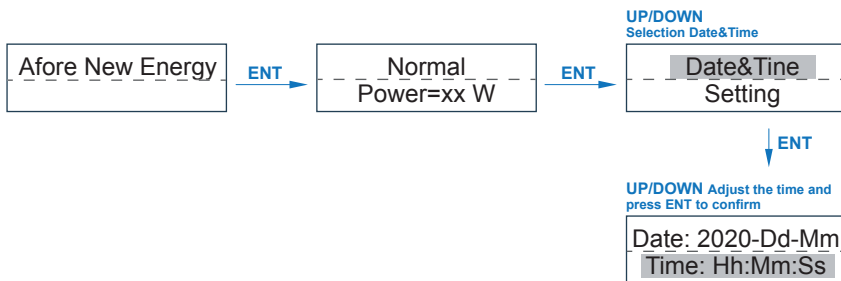

5.3.2 Voltage Range

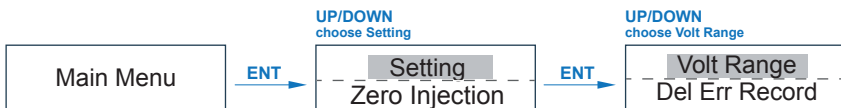

6. Commissioning

Before starting up commissioning at site, please make sure below procedures and requirements are fully meet.

- Mounting location is meet the requirements.
- All of the electrical wiring is firmly connected, including PV wiring, Grid wiring and Earth wiring.
- The inverter setting has been finished accordingly to local standards or regulations.

Commissioning Procedures

- Turn on the AC switch between inverter output and the public grid;
- Turn on the DC switch on the inverter;
- Turn on the PV switch of the system.

7. Shut down & restart inverter

7.1 Shut down

- Turn off the DC switch on the inverter.
- Turn off the DC switch between PV panels and the inverter (if any).
- Close the AC switch between the inverter and the public grid.



Note:

The inverter will be operable after minimum 5 minutes.

7.2 Restart

- Shut down the inverter according to Chapter 7.1.
- Start-up the inverter according to Chapter 6.

5.Operation

5.1 Control Panel

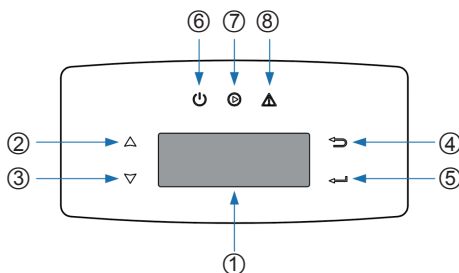

No.	Items	No.	Items
1	LCD Display	5	ENT Touch Button
2	UP Touch Button	6	POWER LED Indicator
3	DOWN Touch Button	7	GRID LED Indicator
4	ESC Touch Button	8	FAULT LED Indicator

Sign	Power	Color	Explanation
POWER	ON	Green	The inverter is stand-by
	OFF		The inverter is power off
GRID	ON	Green	The inverter is feeding power
	OFF		The inverter is not feeding power
FAULT	ON	Red	Fault occurred
	OFF		No fault

8. Maintenance&Trouble Shooting

8.1 Maintenance

Periodically maintenance are necessary, please follow steps as below.

PV connection: twice a year

AC connection : twice a year

Earth connection: twice a year

Heat sink: clean with dry towel once a year.

8.2 Trouble Shooting

Fault messages will be displayed when fault occurs, please according to trouble- shooting table find related solutions.

Type of Fault	Name	Description	Recommend Solution
DC Fault	Bus Low Fault	When inverter is running, bus voltage is lower than the normal value beyond the protection range.	<ul style="list-style-type: none"> • Power off, then restart (Ref. Chapter6) • If fault still occurs continuously and frequently, please ask help for local distributors.
	Bus High Volt	Bus voltage is too high and beyond the protection range.	
	Bus Unbalance	Bus voltage unbalanced, beyond the protection range.	
	DC Offset Fault	The DC component of grid-connected current is too high that beyond the reasonable range.	
System Fault	Over Temperature	The temperature of the installation environment is too high or too low, beyond the reasonable range.	<ul style="list-style-type: none"> • Improve or change the installation environment to adjust the inverter installation environment temperature to normal range. • Power off, then restart (Ref. Chapter6) • If fault still occurs continuously and frequently, please ask help for local distributors.
		The temperature of the cooling device is high or low that beyond the protection range.	
		The temperature of the CPU is high that beyond the protection range.	
	Auto Test Fail	Automatic test failed.	<ul style="list-style-type: none"> • Power off the inverter to check the AC connection, then restart. • If fault still occurs continuously and frequently, please ask help for local distributors.
	No Utility	No continuous utility	
	Grid Volt AD	Grid voltage AD value deviation is too high, beyond the protection range.	<ul style="list-style-type: none"> • Power off, then restart (Ref. Chapter6) • If fault still occurs continuously and frequently, please ask help for local distributors.
	Self Lock	Inverter is locked at the waiting interface.	
	Consistent Fault	The detection results of the two CPUs for the same voltage and frequency are different.	
	Device Fault	Grounding is abnormal or the ground wire is disconnected.	

Type of Fault	Name	Description	Recommend Solution
Inner Warning	Fan Fault	The fan can not work when is started up.	<ul style="list-style-type: none"> • Check if there is objects which blocking the fan rotation and remove it.
	Eeprom Fault	Eeprom abnormal	<ul style="list-style-type: none"> • Power off, then restart (Ref. Chapter6) • If fault still occurs continuously and frequently, please ask help for local distributors.
	Communication Lose	CPU to Flash abnormal	
		CPU to Eeprom abnormal	
		Main CPU to auxiliary abnormal	
		Main CPU to HMI abnormal	

8.Specifications

PV Input Data	HNS3600TL-1	HNS3000TL	HNS3600TL	HNS4000TL	HNS5000TL	HNS6000TL
Max. DC Power (W)	4200	4500	5400	6000	7000	8400
Max. DC Voltage (V)	600	600	600	600	600	600
MPPT Voltage Range (V)	70-500	70-550	70-550	70-550	70-550	70-550
MPPT Full Power Voltage Range (V)	130-500	110-550	130-550	145-550	180-550	220-550
Rated Input Voltage (V)	360	360	360	360	360	360
Start-up Voltage (V)	70	70	70	70	70	70
Max. Input Current (A)	14	14 x 2	14 x 2	14 x 2	14 x 2	14 x 2
Max. Short Current (A)	18	18 x 2	18 x 2	18 x 2	18 x 2	18 x 2
No. of MPP Tracker / No. of PV String	1/1	2/2	2/2	2/2	2/2	2/2
Input Connector Type	MC4	MC4	MC4	MC4	MC4	MC4
AC Output Data	HNS3600TL-1	HNS3000TL	HNS3600TL	HNS4000TL	HNS5000TL	HNS6000TL
Max. Output Power (W)	3960	3300	3960	4400	5500	6600
Nominal Output Power (W)	3600	3000	3600	4000	5000	6000
Max. Output Current (A)	17.5	15	17.5	20	24	28.7
Nominal Output Voltage (V)	L/N/PE, 220Vac, 230Vac, 240Vac					
Grid Voltage Range	180Vac-276Vac (According to local standard)					
Nominal Output Frequency (Hz)	50/60					
Grid Frequency Range	45~55Hz/54~66Hz (According to local standard)					
Output Power Factor	1 default (adjustable from 0.8 leading to 0.8 lagging)					
Output Current THD	<3%					
Efficiency	HNS3600TL-1	HNS3000TL	HNS3600TL	HNS4000TL	HNS5000TL	HNS6000TL
Max. Efficiency	98.20%	98.20%	98.20%	98.20%	98.20%	98.20%
Euro Efficiency	97.80%	97.80%	97.82%	97.85%	97.90%	97.92%
Protection	HNS3600TL-1	HNS3000TL	HNS3600TL	HNS4000TL	HNS5000TL	HNS6000TL
PV Reverse Polarity Protection	YES	YES	YES	YES	YES	YES
PV Insulation Resistance Detection	YES	YES	YES	YES	YES	YES
AC Short Circuit Protection	YES	YES	YES	YES	YES	YES
AC Over Current Protection	YES	YES	YES	YES	YES	YES
AC Over Voltage Protection	YES	YES	YES	YES	YES	YES
Anti-Islanding Protection	YES	YES	YES	YES	YES	YES
Residual Current Detection	YES	YES	YES	YES	YES	YES
Over Temperature Protection	YES	YES	YES	YES	YES	YES
Integrated DC switch	YES	YES	YES	YES	YES	YES
Surge Protection	Integrated (Type III)					
General Data	HNS3600TL-1	HNS3000TL	HNS3600TL	HNS4000TL	HNS5000TL	HNS6000TL
Dimensions (W x H x D, mm)	358×360×142					
Weight (kg)	10					
Protection Degree	IP65					
Enclosure Material	Aluminum					
Ambient Temperature Range (°C)	-25 ~ +60°C (Derating 45°C)					
Humidity Range	0-100%					
Topology	Transformerless					
Communication Interface	RS485 / WiFi / Wire Ethernet / GPRS (optional)					
Cooling Concept	Convection					
Noise Emission (db)	<28					
Night Power Consumption (W)	<1					
Max. Operation Altitude (m)	4000					
Certifications and Standards	HNS3600TL-1	HNS3000TL	HNS3600TL	HNS4000TL	HNS5000TL	HNS6000TL
EMC Standard	EN/IEC 61000-6-2, EN/IEC 61000-6-3, EN61000-3-2, EN61000-3-3, EN61000-3-11, EN61000-3-12					
Safety Standard	IEC 60068, IEEE1547, EN62109					
Grid-connection	EN50549-1, EN50438, RD 1699, UNE 217001, RD 413, IEC61727, IEC62116, IEC61683, VDE4105, UL1741 VDE0126 AS4777.2 NB/T 32004-2018, UNT C 15-712-1, ABNT NBR 16149, ABNT NBR 16150					



Afore New Energy Technology (Shanghai) Co., LTD

ADD: Building 7, No.333 Wanfang Rd, Minhang District, Shanghai, China.

TEL: +86-21-5432 6236

FAX: +86-21-5432 6136

www.aforenergy.com

RCD Selections for Afore inverters

Residual Current Monitoring Device (RCMD)

All Afore inverters integrated an all-current sensitive residual-current monitoring device (RCMD), the RCMD monitors AC and DC residual currents. The inverters integrated with RCMD are certificated by testing according to VDE 0126-1-1 and IEC/EN 62109-2, for all inverters, sudden changes in residual current $\geq 30\text{mA}$ will cause inverter disconnect from grid, for inverter $\leq 30\text{kVA}$ slow rising residual current $\geq 300\text{mA}$ will cause inverter disconnect from grid, and for inverters $> 30\text{kVA}$ the maximum 10mA per kVA of rated continuous output power is the limit value.

External RCD device

An external RCD is required in some countries, Afore suggest to use a Type A RCD and have an operating current of 300mA for inverter power rating up to 20kW . For inverter power rating above 20kW , suggest to use RCD above 300mA , must bigger than 10mA/kVA of continuous output power.

Note:

For Multiple inverters, one RCD for each inverter is required. An RCD of 30mA may easy trip due to capacitive leakage currents occurring during operation

